

APTITUDE[®]

STANDARD & MIDLINE
ANTERIOR CERVICAL PLATE SYSTEM



Features & Benefits



CURITEVA[®]

APTITUDE® STANDARD & MIDLINE ANTERIOR CERVICAL PLATES

The Aptitude® Cervical Plates feature a slim profile design allowing for a smooth anterior surface. The simple and intuitive one step locking mechanism facilitates complete control by the surgeon during the procedure. All system components are manufactured from biocompatible titanium alloy.



Part Number: C154-XX-YY
(XX - Levels, YY - Length)

Plate Lengths

One Level: 10, 12, 14, 16, 18, 20, 22, 24, & 26 mm

Two Level: 24, 27, 30, 33, 36, 39, 42, 45, 48 mm

Three Level: 39, 42, 45, 48, 51, 54, 57, 60, 63 mm

Four Level: 60, 64, 68, 72, 76, 80, & 84 mm

Five Level: 76, 80, 84, 88, 92, 96, 100, & 104 mm

Plates - Standard Features:

- 17mm plate width
- 2.2mm thick, low profile design
- Large graft windows allow for enhanced graft and endplate visualization
- Pre-Lordosed design reduces the need for contouring
- Dedicated bend zones
- Posterior ridges resist slippage and increase torsional stability

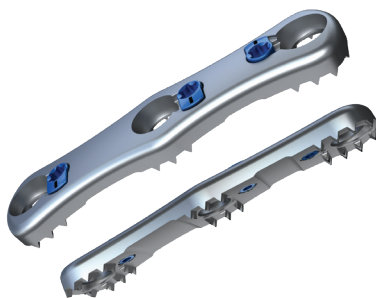

Part Number: C164-XX-YY
(XX - Levels, YY - Length)

Plate Lengths

One Level: 12, 14, 16, 18, 20, 22, 24, & 26 mm

Two Level: 26, 28, 30, 32, 34, 36, 38, 40, 42 mm

Plates - Midline Features:

- 10.5mm plate width
- 2.2mm thick, low profile design
- Allows for a small incision, minimizing lateral retraction of soft tissue
- Narrow width optimizes post-operative visualization of the fusion site
- Posterior cleats resist slippage and increase torsional stability

Screw Features:

- Ø4.0 and Ø4.5 in 12-18mm lengths (in 2mm increments)
- 5° medial biased at all screw holes
- 5° cephalad/caudal biased at end screw holes
- 22° conical screw angulation at all screw holes, with 27° angulation at cephalad/caudal screw holes

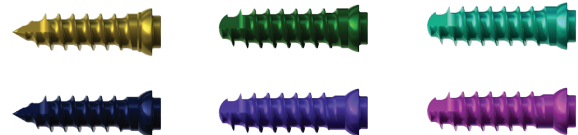

Part Number:

C154-40XX-FSD - Self-Drilling, Fixed Screw, Ø4.0

C154-40XX-VSD - Self-Drilling, Variable Screw, Ø4.0

C154-40XX-FST - Self-Tapping, Fixed Screw, Ø4.0

C154-40XX-VST - Self-Tapping, Variable Screw, Ø4.0

C154-45XX-FST - Self-Tapping, Fixed Rescue Screw, Ø4.5

C154-45XX-VST - Self-Tapping, Variable Rescue Screw, Ø4.5
(XX - Length)



For more information or to place an order call: 877.9CURITEVA,
email: customersupport@curiteva.com or visit www.curiteva.com

Products patented and/or patent pending.
All products are not currently available in all markets.

Copyright©2021 by Curiteva, Inc.
QMSF-1122 Rev 3.0